

IMPORTANT - READ CAREFULLY BEFORE INSTALLING FIXTURE. RETAIN THESE INSTRUCTIONS FOR FUTURE REFERENCE.

THIS PRODUCT MUST BE INSTALLED IN ACCORDANCE WITH THE NATIONAL ELECTRICAL CODE AND ALL APPLICABLE LOCAL CODES, BY A PERSON FAMILIAR WITH THE CONSTRUCTION AND OPERATION OF THE PRODUCT, AND THE HAZARDS INVOLVED. PROPER GROUNDING IS REQUIRED FOR SAFETY. USE ONLY IN DRY LOCATIONS.

NOTE - TRACK IS UL LISTED STRICTLY FOR 120V, 60Hz, 20A OR 120V, 60Hz, 5.5A WITH CANOPY KIT INSTALLATION. NOT FOR USE WITH REMOTE TRANSFORMER(S).

DIMMING - INCANDESCENT LUMINAIRE ACCEPTS STANDARD ROTARY OR SLIDE DIMMER. SELECT DIMMER WITH AMPLE CAPACITY FOR TOTAL NUMBER OF TRACK FIXTURES. ELECTRIC LOW VOLTAGE FIXTURES REQUIRE USE OF SOLID-STATE (ELECTRONIC) DIMMER CONTROL CAPABLE OF DIMMING TRANSFORMERS.

EXAMPLE: LUTRON, COMPACT FLUORESCENT AND HID FIXTURES CANNOT BE DIMMED. FOR LED LUMINAIRE, REFER TO THE FIXTURE'S INSTALLATION SHEET.

SINGLE CIRCUIT TRACK PREPARATION INSTRUCTIONS

IF TRACK NEED TO BE CUT ON-SITE, COMPLETE THE FOLLOWING STEPS TO ASSURE FUNCTIONAL TRACK:

A- USING A METAL SAW, CUT THE TRACK SECTION STRAIGHT.

***ALUMINUM TRACK AND PLASTIC INSULATOR MUST BE CUT THE SAME LENGTH.**

B- AFTER CUTTING TO PROPER LENGTH, ALL COPPER CONDUCTORS MUST BE CUT BACK 3/8" FROM EACH END TO PREVENT ARCING AND ALLOW COUPLING, POWER FEEDS OR END CAPS TO BE INSERTED COMPLETELY.

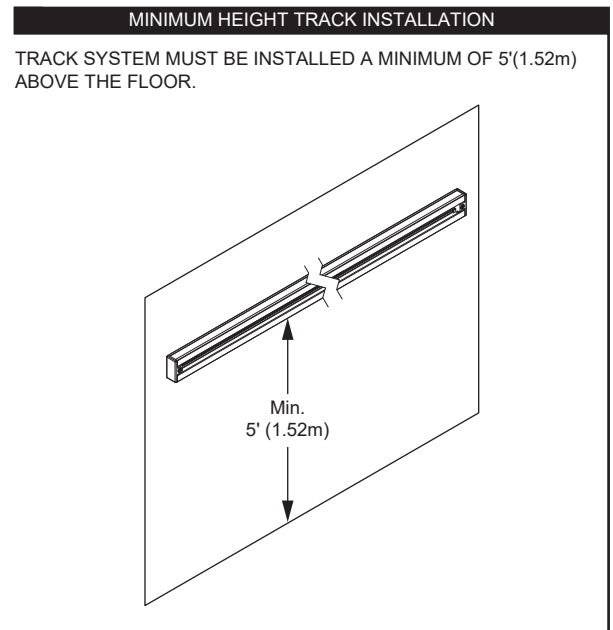
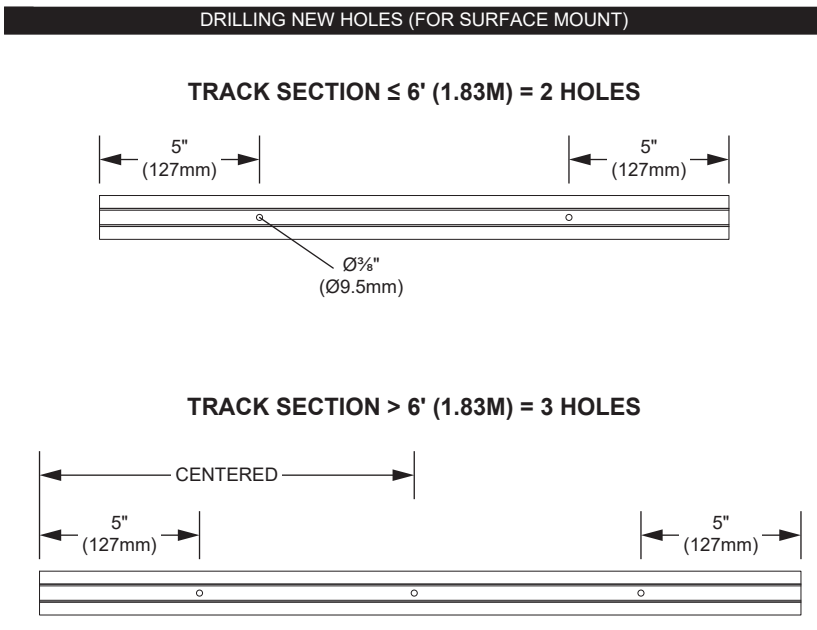
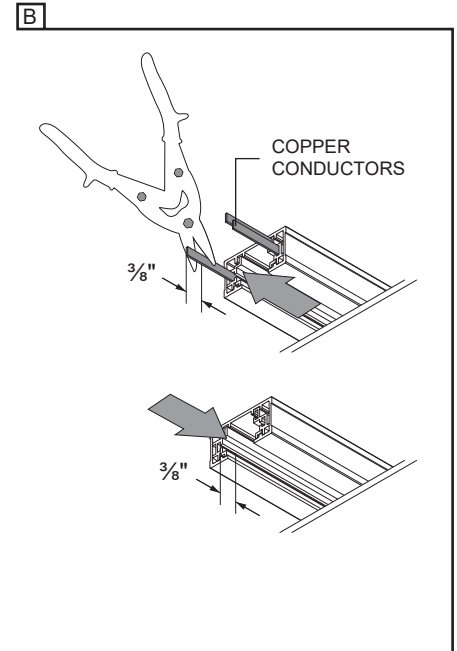
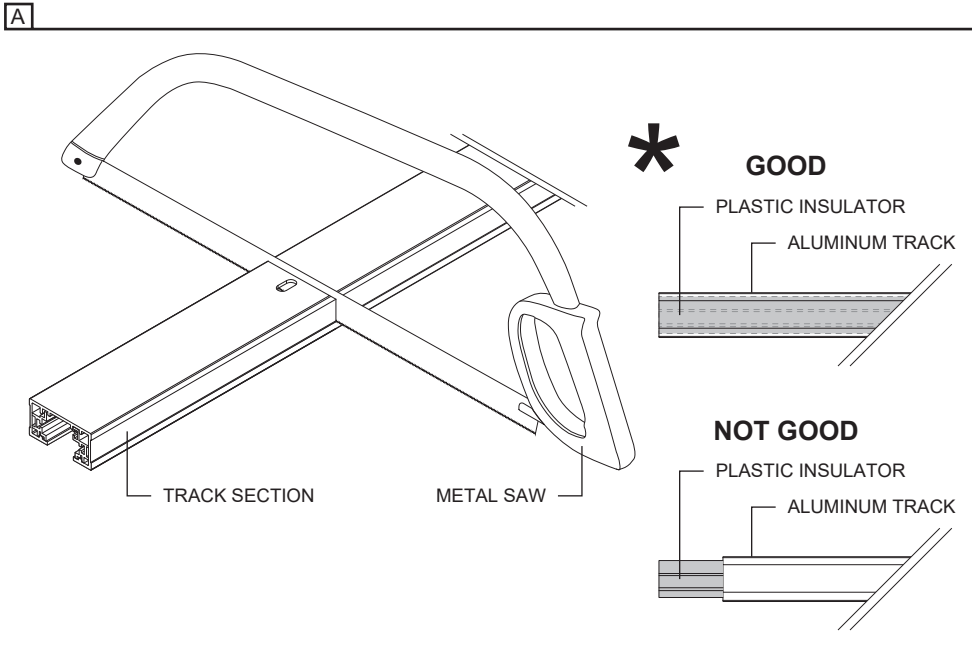

**SURFACE TRACK END FEEDER 4" JUNCTION BOX INSTALLATION (8014-S1)
120V**

- A- UNSCREW THE COVER'S PHILLIPS SCREW AND REMOVE THE END FEEDER COVER.
- B- SCREW THE NIPPLE FITTING (**INCLUDED**) TO THE CROSSBAR (**INCLUDED**) BEFORE INSTALLING IT TO THE JUNCTION BOX USING THE (2) PHILLIPS SCREWS (**INCLUDED**). PASS THE END FEEDER BRACKET AROUND THE NIPPLE FITTING THEN USE THE LOCKNUT (**INCLUDED**) TO SECURE THE END FEEDER AGAINST THE CROSSBAR. **PAY ATTENTION TO THE ORIENTATION.**
- C- PASS THE BRANCH CIRCUIT WIRES THROUGH AND MAKE THE NECESSARY CONNECTIONS (**FOLLOWING POLARITY MARKINGS**) INSIDE THE END FEEDER BRACKET.
- D- SCREW THE COVER BACK ON.
- E- SLIDE A TRACK SECTION INTO THE END FEEDER.
- F- USE THE TRACK SECTION(S) TO TRACE MOUNTING HOLE POSITIONS.
- G- REMOVE THE TRACK SECTION AND SCREW THE PREFERRED SURFACE ANCHOR (**NOT INCLUDED**) INTO TRACED HOLES.

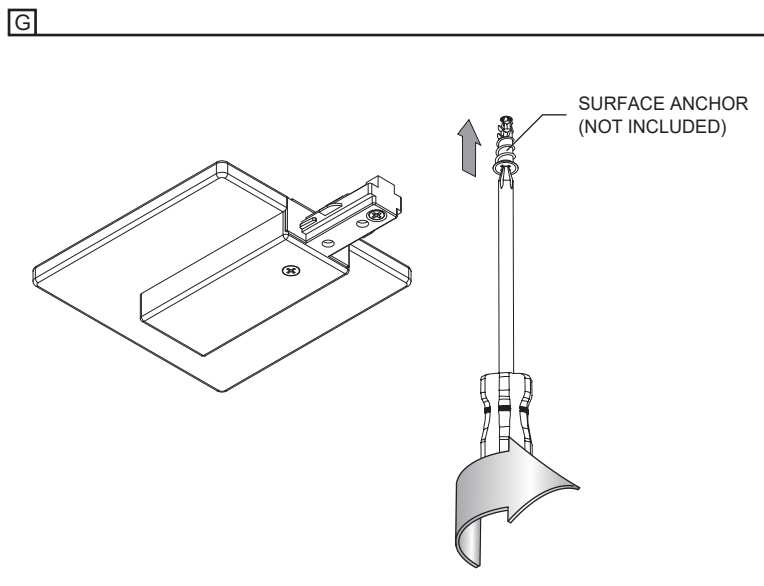
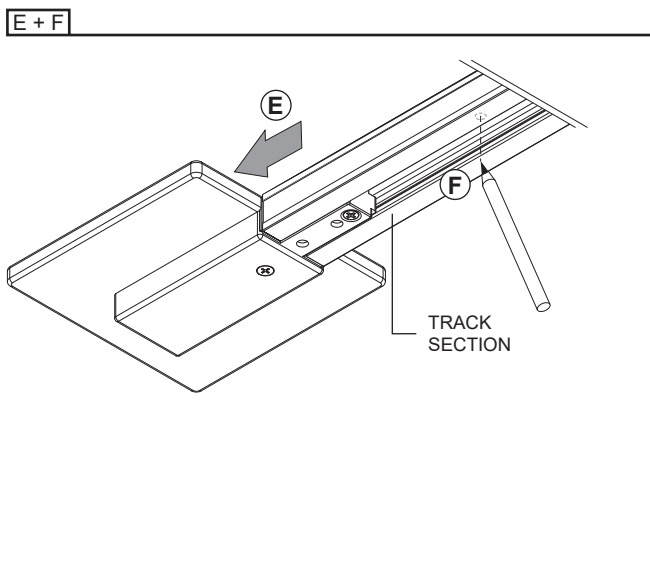
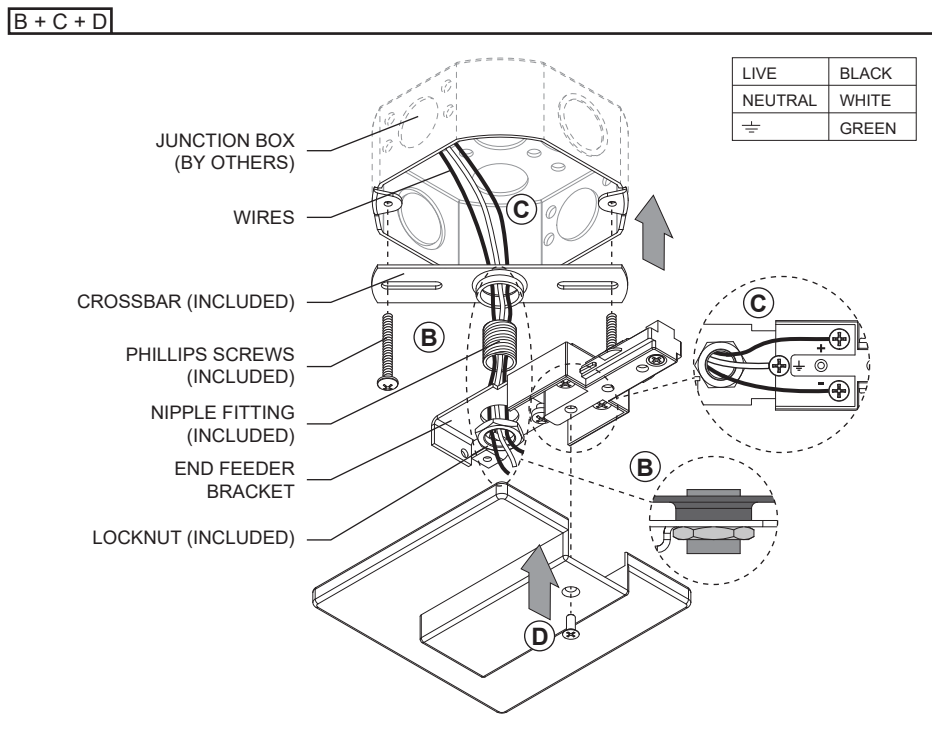
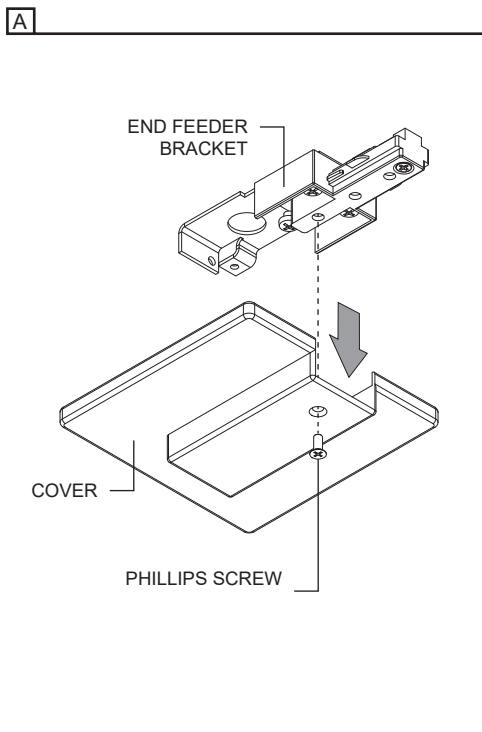

E- SLIDE A TRACK SECTION INTO THE END FEEDER.

F- SCREW TRACK TO SURFACE USING #8 SCREWS (**NOT INCLUDED**).

E + F

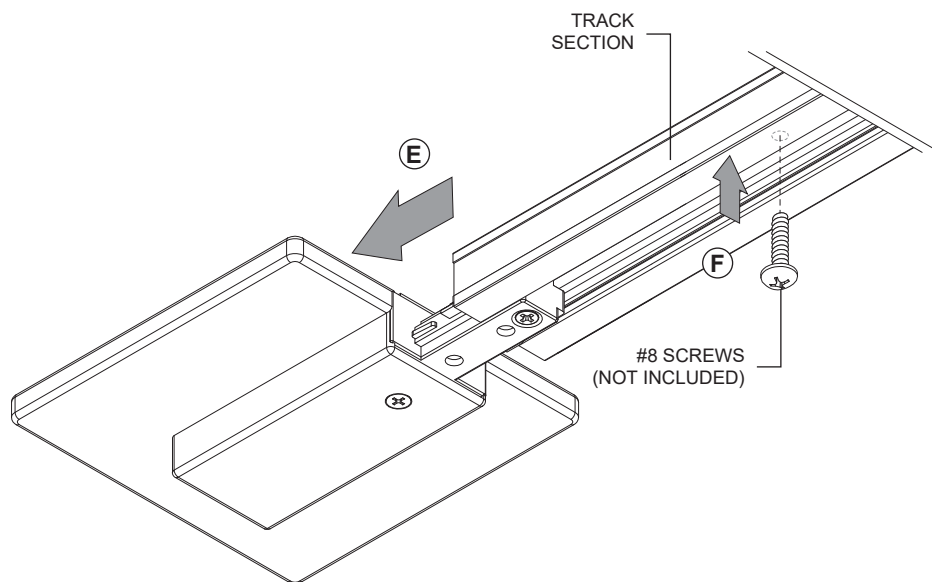

**SURFACE TRACK FLOATING FEEDER INSTALLATION (8016-S1)
120V**

- A- UNSCREW COMPLETELY THE (2) PHILLIPS SCREWS (**INCLUDED**) FROM THE COVER.
- B- UNTIGHTEN THE (2) PHILLIPS SCREWS (**INCLUDED**) FROM CROSSBAR (**DO NOT REMOVE SCREWS**)
- C- MAKE WIRE CONNECTIONS (**SEE WIRING DIAGRAM**) INSIDE JUNCTION BOX USING TWIST CONNECTORS (**INCLUDED**).
- D- INSTALL THE CROSSBAR ON JUNCTION BOX USING (2) 8-32 SCREWS (**NOT INCLUDED**).
- E- PLACE THE TRACK SECTION ON THE CROSSBAR AND TIGHTEN THE (2) PHILLIPS SCREWS TO HOLD THE TRACK TEMPORARILY.
- F- USE THE TRACK SECTION TO TRACE EACH MOUNTING HOLE POSITION.
- G- LOOSEN THE (2) CROSSBAR PHILLIPS SCREWS AND REMOVE THE TRACK SECTION.
- H- TO INSTALL THE TRACK SYSTEM WITH THE SPRING TOGGLE SCREWS (**INCLUDED**), DRILL $\frac{1}{2}$ "(39mm) HOLES INTO SURFACE.
(FOR DRYWALL SURFACE ONLY, NO MOUNTING ACCESSORIES INCLUDED FOR OTHER SURFACES.)

A + B

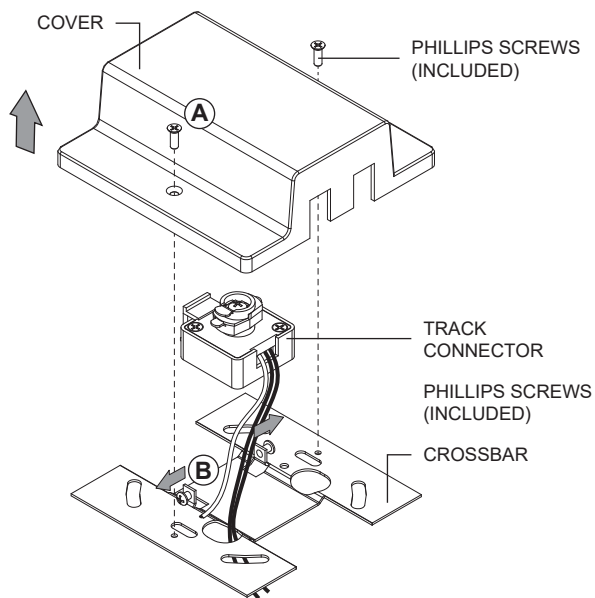

C + D

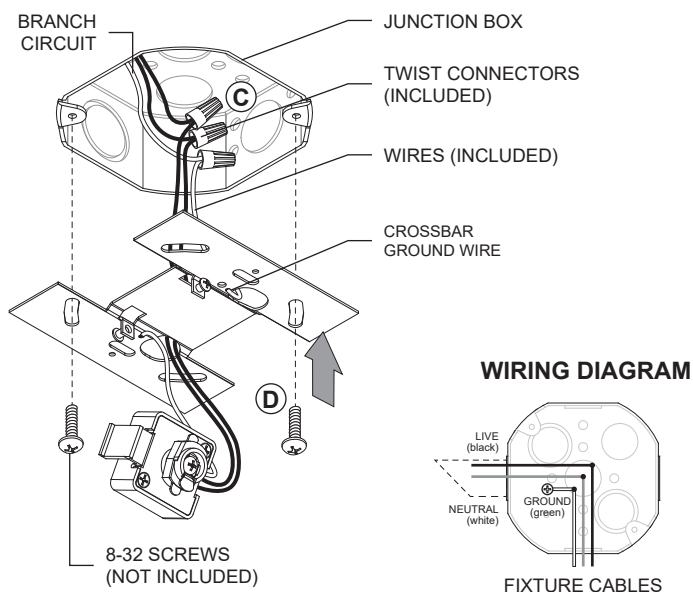

E + F + G

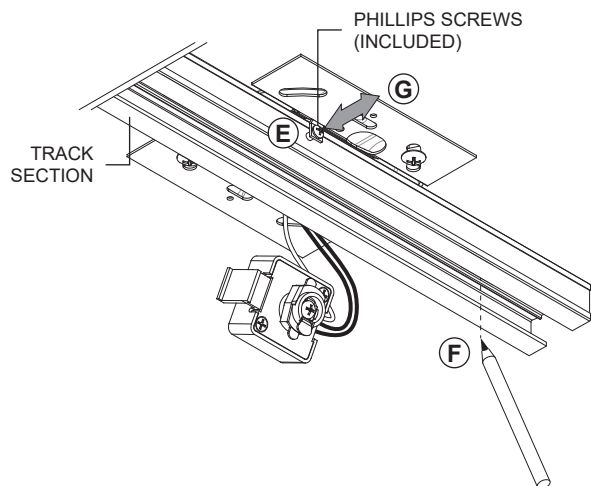

H

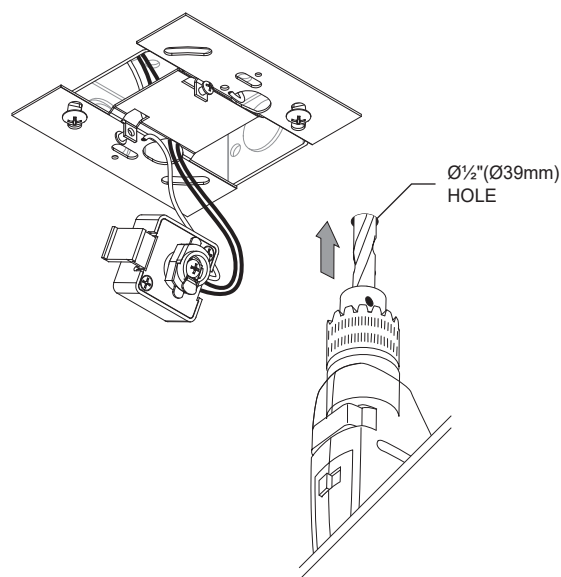

- I- PLACE THE TRACK SECTION ON THE CROSSBAR AND TIGHTEN THE (2) PHILLIPS SCREWS TO HOLD THE TRACK IN PLACE.
- J- **PHILLIPS 3/16" SPRING TOGGLE SCREWS (INCLUDED) INSTALLATION:**
 - 1- PASS THE 3" PHILLIPS SCREW THROUGH THE TRACK SECTION AND SCREW THE TOGGLE SPRING ON THE SCREW.
 - 2- PINCH THE TOGGLE SPRING AND INSERT THROUGH THE SURFACE. MAKE SURE THE SPRING TOGGLE CAN OPEN UP ONCE INSERTED.
 - 3- SCREW THE TOGGLE SPRING SCREW INTO THE TRACK UNTIL SECURELY SET AGAINST THE SURFACE.
- K- INSERT THE TRACK CONNECTOR INSIDE THE TRACK. WHILE PULLING DOWN THE LOCKING TAB, ROTATE THE TRACK CONNECTOR A QUARTER TURN IN THE PROPER DIRECTION IN ORDER TO MAKE CONTACT BETWEEN THE CONNECTOR'S GROUND CONTACT AND THE TRACK'S GROUND. ONCE THE LOCK TAB IS ALIGNED WITH THE TRACK SLOT, TAB WILL LOCK THE CONNECTOR IN THE TRACK.
- L- INSTALL THE COVER USING (2) PHILLIPS SCREWS (**INCLUDED**). *INSERT END CAP (**INCLUDED**) IF YOU ARE AT THE END OF THE TRACK.

I + J

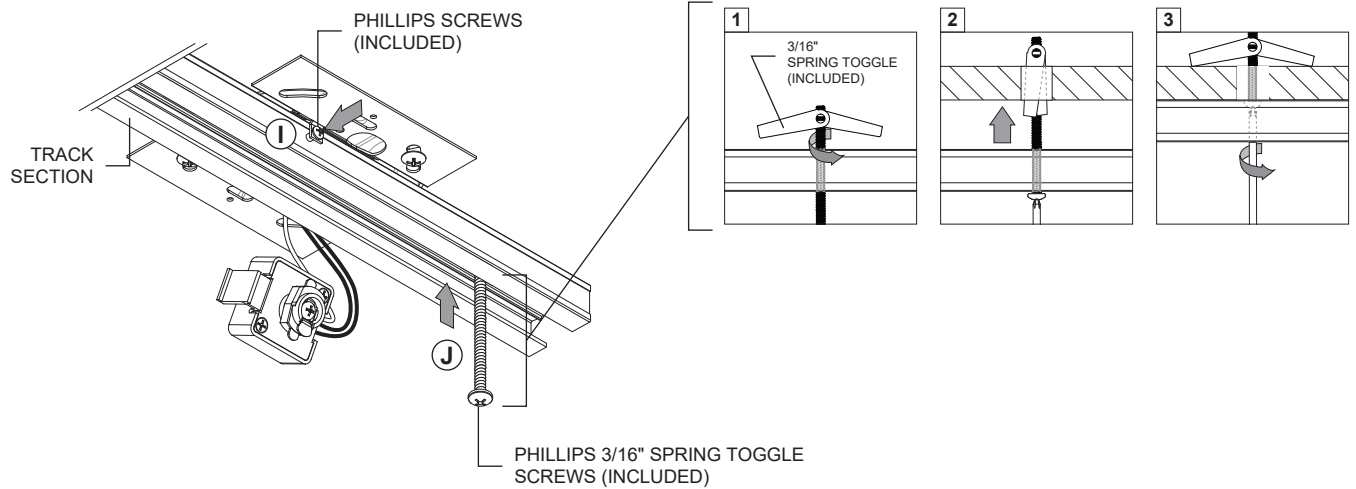

K

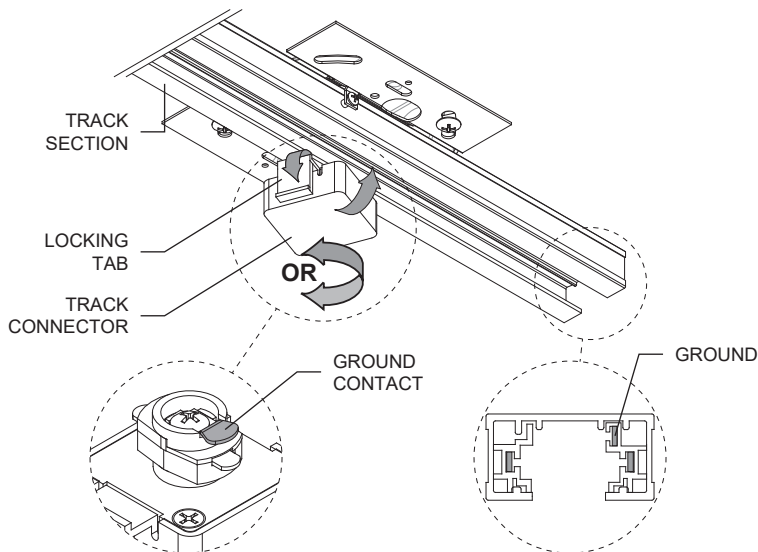

L

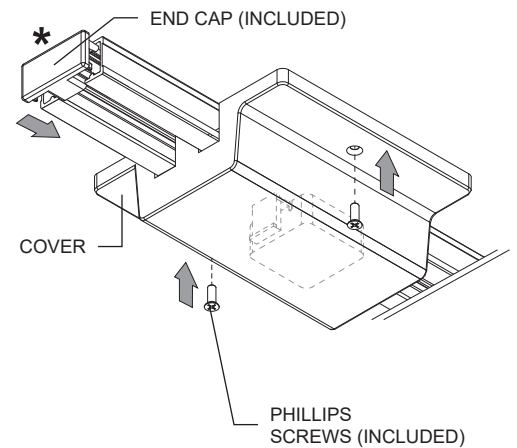

PENDANT INSTALLATION
120V

MAKE SURE THE TRACK IS HELD IN PLACE BY THE AIRCRAFT CABLES, NOT BY THE POWER CABLE. KEEP THE POWER CABLE LOOSE.

DETAIL 1:

- A- PLACE PLASTIC ANCHOR SCREWS (**INCLUDED**) IN THE CEILING AT THE REQUIRED DISTANCE.
- B- PASS SCREW THROUGH THREADED REDUCER RING AND SECURE SCREW INTO PLASTIC ANCHOR SCREW.
- C- FASTEN THE MOUNTING COUPLING CYLINDER ON THREADED REDUCER RING.
- D- ADJUST CABLE LENGTH WITH THE SELF-LOCK CABLE GRIPPER. IF YOU NEED TO ADJUST THE CABLE FOR MORE THAN 6"(152mm), REMOVE THE CABLE FROM THE SELF-LOCK CABLE GRIPPER AND CUT IT TO DESIRED LENGTH. WHEN SET, TIGHTEN THE SELF-LOCK CABLE GRIPPER.

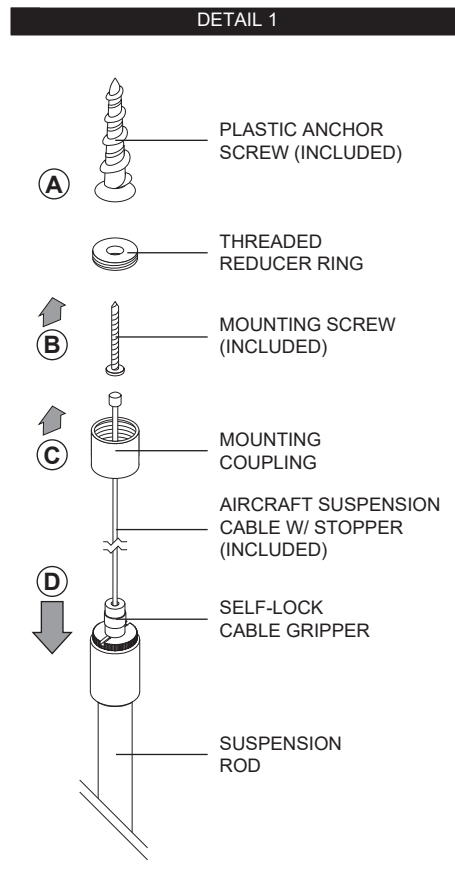
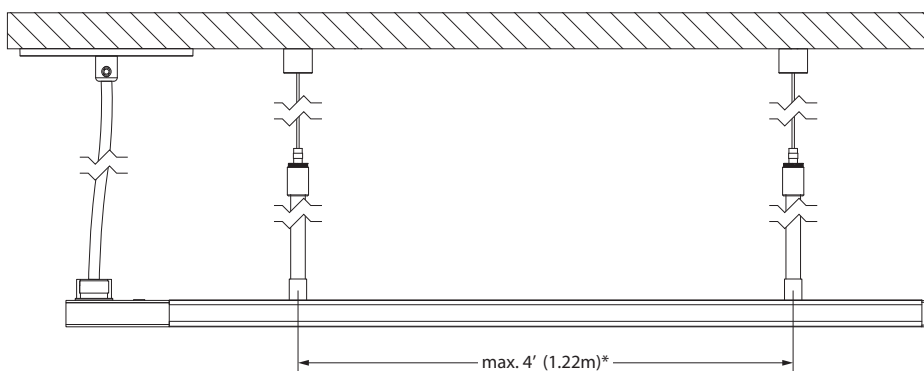
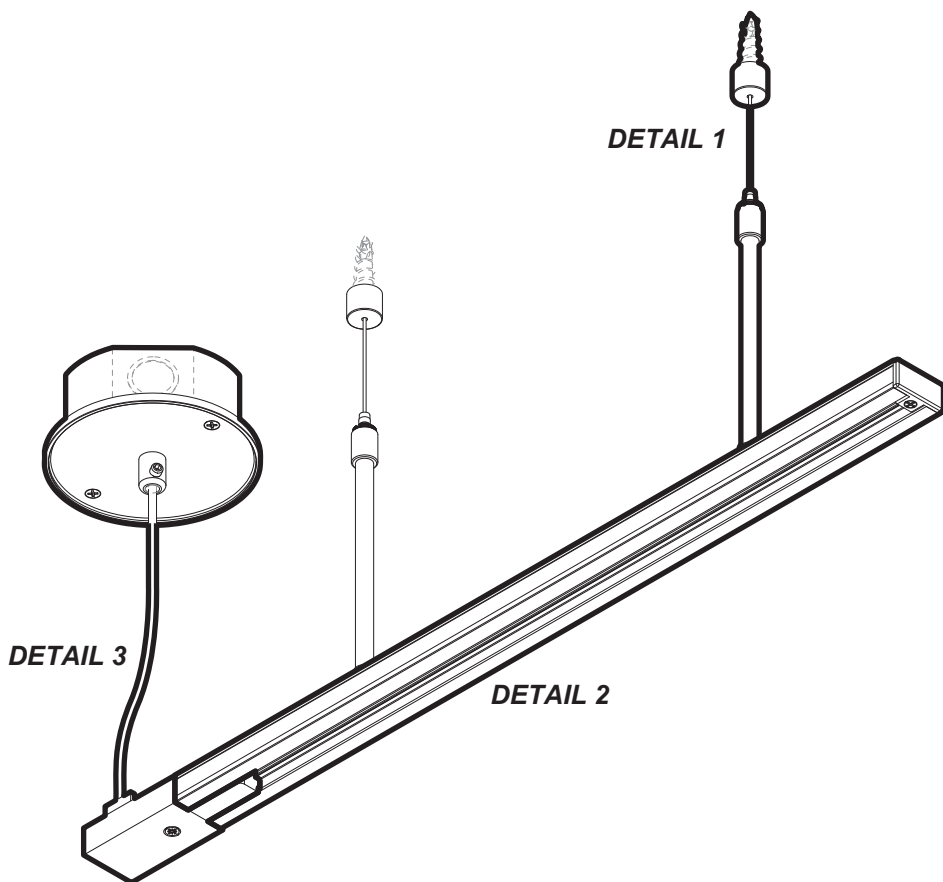

*REFER TO P.1 FOR CUSTOM HOLE DRILLING INSTRUCTIONS

DETAIL 2:

SCREW THE TRACK SECTION TO THE SUSPENSION RODS USING THE (2) PHILLIPS SCREWS (INCLUDED).

*REMOVE END CAP TO ALLOW FOR CONTINUOUS LINE INSTALLATION.

DETAIL 2

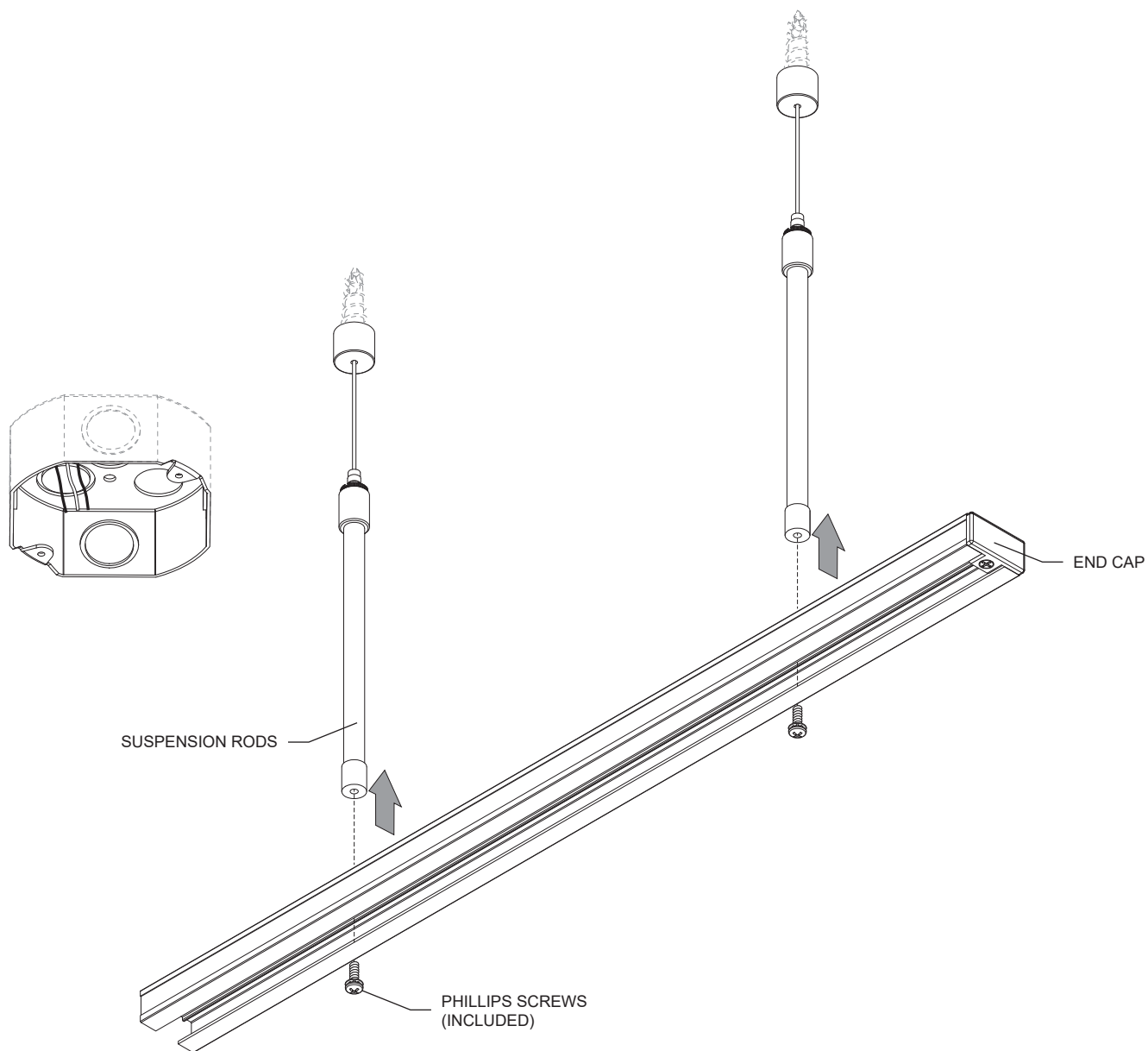

DETAIL 3:

- A- UNSCREW END FEEDER COVER'S PHILLIPS SCREW.
- B- REMOVE KNOCKOUT FROM END FEEDER BRACKET, PASS THE POWER CABLE THROUGH THE CABLE STRAIN RELIEF (INCLUDED) THEN INSERT IT INSIDE THE END FEEDER BRACKET KNOCKOUT.
- C- MAKE THE NECESSARY CONNECTIONS (FOLLOWING POLARITY MARKINGS) INSIDE THE END FEEDER BRACKET.
- D- SCREW COVER BACK ON.
- E- PASS THE POWER CABLE THROUGH THE CANOPY'S CABLE GRIPPER AND ADJUST TO DESIRED LENGTH. **THE POWER CABLE MUST NOT BE USED TO HOLD THE TRACK IN PLACE.**
- F- MAKE WIRE CONNECTIONS (SEE WIRING DIAGRAM) INSIDE JUNCTION BOX USING TWIST CONNECTORS (NOT INCLUDED).
- F- SCREW CANOPY TO THE JUNCTION BOX WITH (2) PHILLIPS SCREWS (INCLUDED).

DETAIL 3

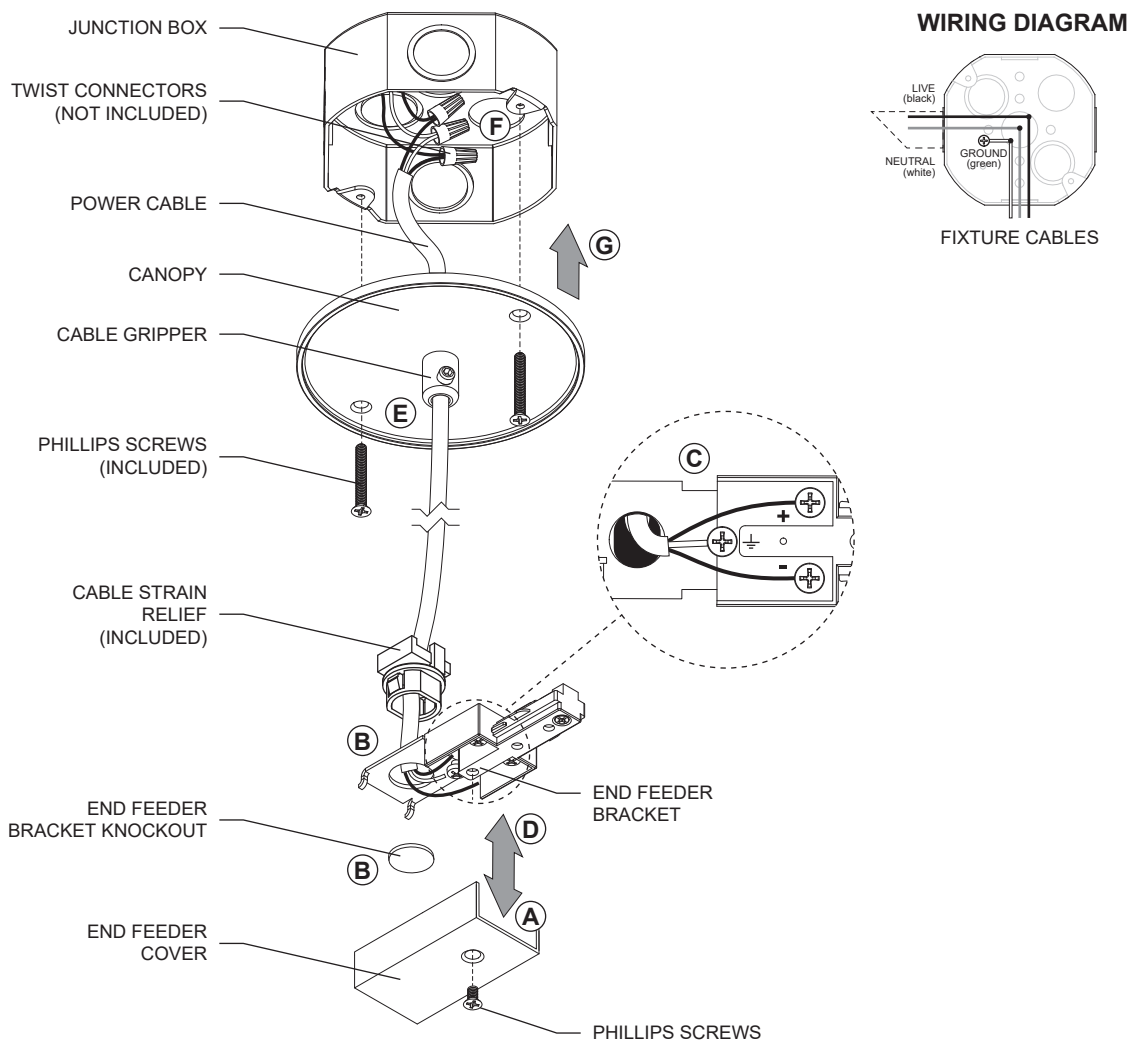

FINAL ASSEMBLY

INSERT END FEEDER BRACKET INTO TRACK SECTION.

